

1000

# SERVICE PARTS LIST

# THE AUSTIN-HEALEY SPRITE

Item No.	DESCRIPTION	Commencing (C) 501		Qty. per Veh.	MODIFICATIONS		REMARKS
		Part Number	Illus. No.		New Part Number	Change Point	
	<b>BONNET, WINGS, AND FITTINGS</b>						
1	Bonnet assembly	14A84	1	1			
2	Panel assembly—bonnet front—bottom	8G9044	1	1	AHA5155	Com. (C) 4695	For cars prior to (C) 4695 see Austin Service Journal A/55.
3	Panel—lower—air intake			1	AHA5308		
4	Panel—side—air intake (R.H.)			1	AHA5394		
5	Panel—side—air intake (L.H.)			1	AHA5395		
6	Panel—front—air intake (R.H.)			1	AHA5396		
7	Panel—front—air intake (L.H.)			1	AHA5397		
8	Channel—support—bonnet			1	AHA5398		
9	Bracket assembly—bonnet stay (R.H.)	AHA5164	2	1			
10	Bracket assembly—bonnet stay (L.H.)	AHA5165	3	1			
11	Strut—bonnet	14A4776	4	2			
12	Screw—strut to bonnet	HZS0405	5	4			
13	Washer for screw (plain)	PWZ104	6	4			
14	Washer for screw (spring)	LWZ204	7	4			
15	Peg—bonnet locating	14A4788	8	2			
16	Washer for locating peg (plain)	58K8428	9	2		Fin. (C) 9190	
17	Washer for locating peg (rubber)			2	AHA5442	Com. (C) 9191	
18	Washer for locating peg (plain)	58K8427	10	2			
19	Washer for locating peg (spring)	LWZ806	11	2			
20	Nut for locating peg	FNZ105	12	2			
21	Wing assembly—front (R.H.)	AHA5162	13	1			
22	Wing assembly—front (L.H.)	AHA5163	14	1			
23	Moulding—bonnet top (R.H.)	14A4778	15	1			
24	Moulding—bonnet top (L.H.)	14A4774	16	1			
25	Moulding—bonnet lower	14A4775	17	2			
26	Filler—lamp	14A4606	18	2			

SERVICE PARTS LIST

THE AUSTIN-HEALEY SPRITE

Item No.	DESCRIPTION	Commencing (C) 501		Qty. per Veh.	MODIFICATIONS		REMARKS
		Part Number	Illus. No.		New Part Number	Change Point	
	<b>Bonnet, Wings, and Fittings—continued</b>						
1	<b>Hinge assembly—bonnet</b>	<b>14A4684</b>	<b>19</b>	<b>2</b>			
2	Packing—bonnet hinge	14A4687	20	2			
3	Screw—hinge to bonnet	HZ50405	21	8			
4	Washer for hinge screw (plain)	PWZ104	22	8			
5	Washer for hinge screw (spring)	LWZ204	23	8			
6	Bolt—hinge to bulkhead	HBZ0524	24	2			
7	Nut for bolt	LNZ205	25	2	LNZ105		For LNZ205 use LNZ105 for this application
8	<b>Stay assembly—telescopic—bonnet</b>	<b>14A4691</b>	<b>26</b>	<b>2</b>			
9	Nut—pivot bracket to pedal box side	FNZ103	27	2			
10	Washer for nut (plain)	PWZ103	28	2			
11	Washer for nut (spring)	LWZ203	29	2			
12	Screw—stay bracket to pedal box	PMZ0408	30	4			
13	Washer for stay bracket screw (plain)	PWZ104	31	4			
14	Washer for stay bracket screw (spring)	LWZ204	32	4			
15	Bolt—special—bonnet stay	14A4705	33	2			
16	Washer for stay bolt (plain)	PWZ105	34	2			
17	Washer for stay bolt (curved)	AWZ105	35	2			
18	Washer for stay bolt—brass (plain)	2K9000	36	2			
19	<b>Stay—bonnet—auxiliary</b>	<b>AHA5232</b>	<b>37</b>	<b>1</b>			
20	Bracket—pivot—bonnet stay	AHA5234	38	1			
21	Washer—stay to bracket (plain)	PWZ105	39	1			
22	Washer—stay to bracket (spring)	AJD7731	40	1			
23	Screw—bracket to radiator supports (R.H.)	HZ50405	41	1			
24	Washer for screw (plain)	PWZ104	42	1			
25	Washer for screw (spring)	LWZ204	43	1			
26	Nut for screw	FNZ104	44	1			
27	Bracket—clip—bonnet stay	AHA5233	45	1			
28	Clip—bonnet stay	AHH5460	46	1			
29	Screw—clip to bracket	PMZ0306	47	2			
30	Washer for screw (spring)	LWZ203	48	2			
31	Nut for screw	FNZ103	49	2			
32	Clip—spring	BNK1500	50	1			
33	Rivet—clip to bonnet reinforcement	CRS0206	51	2			

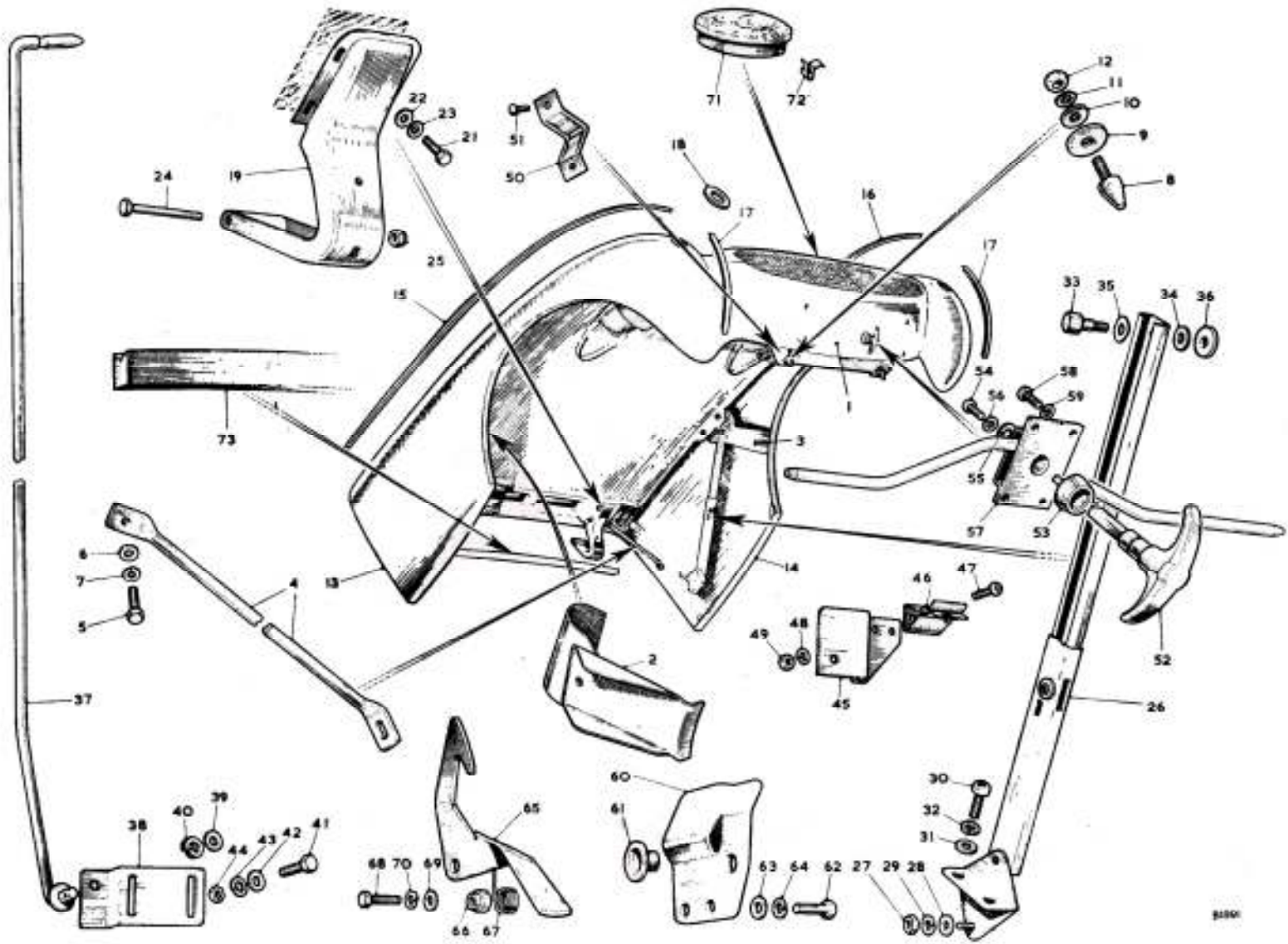

81001



SERVICE PARTS LIST

THE AUSTIN-HEALEY SPRITE

Item No.	DESCRIPTION	Commencing (C) 501		Qty. per Veh.	MODIFICATIONS		REMARKS
		Part Number	Illus. No.		New Part Number	Change Point	
	<b>Bonnet, Wings, and Fittings—continued</b>						
1	<b>Handle—bonnet</b>	<b>14A4891</b>	<b>52</b>	<b>1</b>			
2	Escutcheon—handle	14A4892	53	1			
3	Screw—handle to lock	6K9833	54	1			
4	Washer for screw (plain)	PWZ103	55	1			
5	Washer for screw (spring)	LWZ203	56	1			
6	<b>Lock assembly—bonnet</b>	<b>14A4712</b>	<b>57</b>	<b>1</b>			
7	Screw—lock to bonnet	PMZ0308	58	4			
8	Washer for screw (spring)	LWZ203	59	4			
9	<b>Bracket assembly—bonnet lock striker (R.H.)</b>	<b>AHA5150</b>	<b>60</b>	<b>1</b>			
10	<b>Bracket assembly—bonnet lock striker (L.H.)</b>	<b>AHA5151</b>	<b>61</b>	<b>1</b>			
11	Bush—striker plate	14A4714	61	2			
12	Screw—bracket to side-member	HN50405	62	4			
13	Washer for screw (plain)	AHA5329	63	4			
14	Washer for screw (spring)	LWZ204	64	4			
15	<b>Catch—safety—bonnet</b>	<b>14A4707</b>	<b>65</b>	<b>1</b>			
16	Bush—safety catch	14A4708	66	1			
17	Spring—safety catch	14A4709	67	1	AHA5472	Fin. (C) 16150 Com. (C) 16151	Use Part No. AHA5472
18	Bolt—safety catch to side-member	HN50408	68	1			
19	Washer for screw (plain)	AHA5329	69	1			
20	Washer for bolt (spring)	LWZ204	70	1			
21	<b>Badge—bonnet top</b>	<b>14A4898</b>	<b>71</b>	<b>1</b>			
22	Clip—badge to bonnet top	14A5542	72	3			
23	Seal—bonnet sealing	AHA5223	73	1			

SERVICE PARTS LIST

THE AUSTIN-HEALEY SPRITE

Item No.	DESCRIPTION	Commencing (C) 501		Qty. per Veh.	MODIFICATIONS		REMARKS
		Part Number	Illus. No.		New Part Number	Change Point	
<b>SEAT AND SEAT FITTINGS</b>							
1	Squab assembly—Cherry Red with White piping	AHA5040	1	2			
2	Squab assembly—Blue with Light Blue piping	AHA5042		2			
3	Squab assembly—Black with Yellow piping	AHA5043		2			
4	Squab assembly—Black with White piping			2	AHA5461	Fin. (1) 9604 Com. (1) 9605	
5	Squab assembly—Green with Green piping	AHA5044		2			
6	Cover assembly—squab—Cherry Red with White piping	AHA5045		2			
7	Cover assembly—squab—Blue with Light Blue piping	AHA5047		2			
8	Cover assembly—squab—Black with Yellow piping	AHA5048		2			
9	Cover assembly—squab—Black with White piping			2	AHA5402	Fin. (1) 9604 Com. (1) 9605	
10	Cover assembly—squab—Green with Green piping	AHA5049		2			
11	Clip—trim	14A4497	2	36			
12	Nut—squab to pivot bracket	AHA5219		4			
13	Washer for nut (plain)	PW 2205		8			
14	Cushion assembly—Cherry Red with White piping	AHA5030	3	2			
15	Cushion assembly—Blue with Light Blue piping	AHA5032		2			
16	Cushion assembly—Black with Yellow piping	AHA5033		2			
17	Cushion assembly—Black with White piping			2	AHA5450	Fin. (5) 9604 Com. (5) 9605	
18	Cushion assembly—Green with Green piping	AHA5034		2			
19	Cover assembly—cushion—Cherry Red with White piping	AHA5035		2			
20	Cover assembly—cushion—Blue with Light Blue piping	AHA5037		2			
21	Cover assembly—cushion—Black with Yellow piping	AHA5038		2			
22	Cover assembly—cushion—Black with White piping			2	AHA5400	Fin. (5) 9604 Com. (5) 9605	
23	Cover assembly—cushion—Green with Green piping	AHA5039		2			
24	Cushion (foam rubber)	14A4787		2			
25	Clip—trim	14A4497		36			