

SERVICE PARTS LIST

THE AUSTIN-HEALEY SPRITE

Item No.	DESCRIPTION	Commencing (C) 501		Qty. per Veh.	MODIFICATIONS		REMARKS
		Part Number	Illus. No.		New Part Number	Change Point	
	<b>SUNDRIES</b>						
1	Door assembly—heater outlet	13H59	1	2			
2	Screw—outlet door to footwell side	PTZ608	2	8			
3	Plate—cover—footwell	2A5589	3	1			
4	Washer for cover-plate (joint)	2A5549	4	1			
5	Screw—plate to footwell	HZS0405	5	8			
6	Plate—blanking—heater platform	14A4790	6	1			] Not required when heater or fresh-air unit is fitted
7	Sealer—blanking plate	14A4791	7	1			
8	Screw—blanking plate fixing	PMZ0408	8	4			
9	Washer for blanking plate screw (spring)	LWZ204	9	4			
10	Washer for blanking plate screw (plain)	PWZ204	10	4			
11	Plate—cover—engine undershield (R.H.)	AHA5210	11	1		] Fin. (C) 5476, except 5137, 5287, 5288	
12	Screw—plate fixing	PMZ0408	12	2			
13	Washer for screw (plain)	PWZ104	13	2			
14	Washer for screw (spring)	LWZ204	14	2			
15	<b>Over-rider assembly</b>	14A4734	15	2			
16	Bracket—over-rider (internal)	14A8411	16	2			
17	Screw—bracket to luggage floor	HZS0504	17	2			
18	Washer for screw (spring)	LWZ205	18	2			
19	Washer for screw (plain)	PWZ105	19	2			
20	Bracket—fixing—over-rider (upper)	14A4738	20	2			
21	Screw—bracket to internal bracket	HZS0507	21	2			
22	Washer for screw (spring)	LWZ205	22	2			
23	Washer for screw (plain)	PWZ105	23	2			
24	Bracket—fixing—over-rider (lower)	14A4739	24	2			
25	Screw—bracket to internal bracket	HZS0506	25	4			
26	Washer for screw (spring)	LWZ205	26	4			
27	Washer for screw (plain)	PWZ105	27	4			
28	Screw—over-rider to brackets	HZS0506	28	4			
29	Washer for screw (spring)	LWZ205	29	4			
30	Washer for screw (plain)	PWZ105	30	4			
31	Washer—upper bracket to body (rubber)	2K9679	31	2			
32	<b>Plate—number (front)</b>	14A4659	32	1			] Not required when bumper is fitted
33	Screw—plate fixing	PMZ0306	33	4			
34	Washer for screw (plain)	PWZ203	34	4			
35	Washer for screw (spring)	LWZ203	35	4			
36	Nut for screw	FNZ103	36	4			
37	<b>Flash—'Sprite'</b>	14A4659	37	1			
38	Push-on fix—flash to back panel	PES104	38	2			
39	<b>Mirror—interior—rear view</b>	14A5473	39	1			
40	Glass	27H9782		1			
41	Bracket—fixing	27H9781		1			
42	Screw—mirror to scuttle top	RMP0808	40	2			

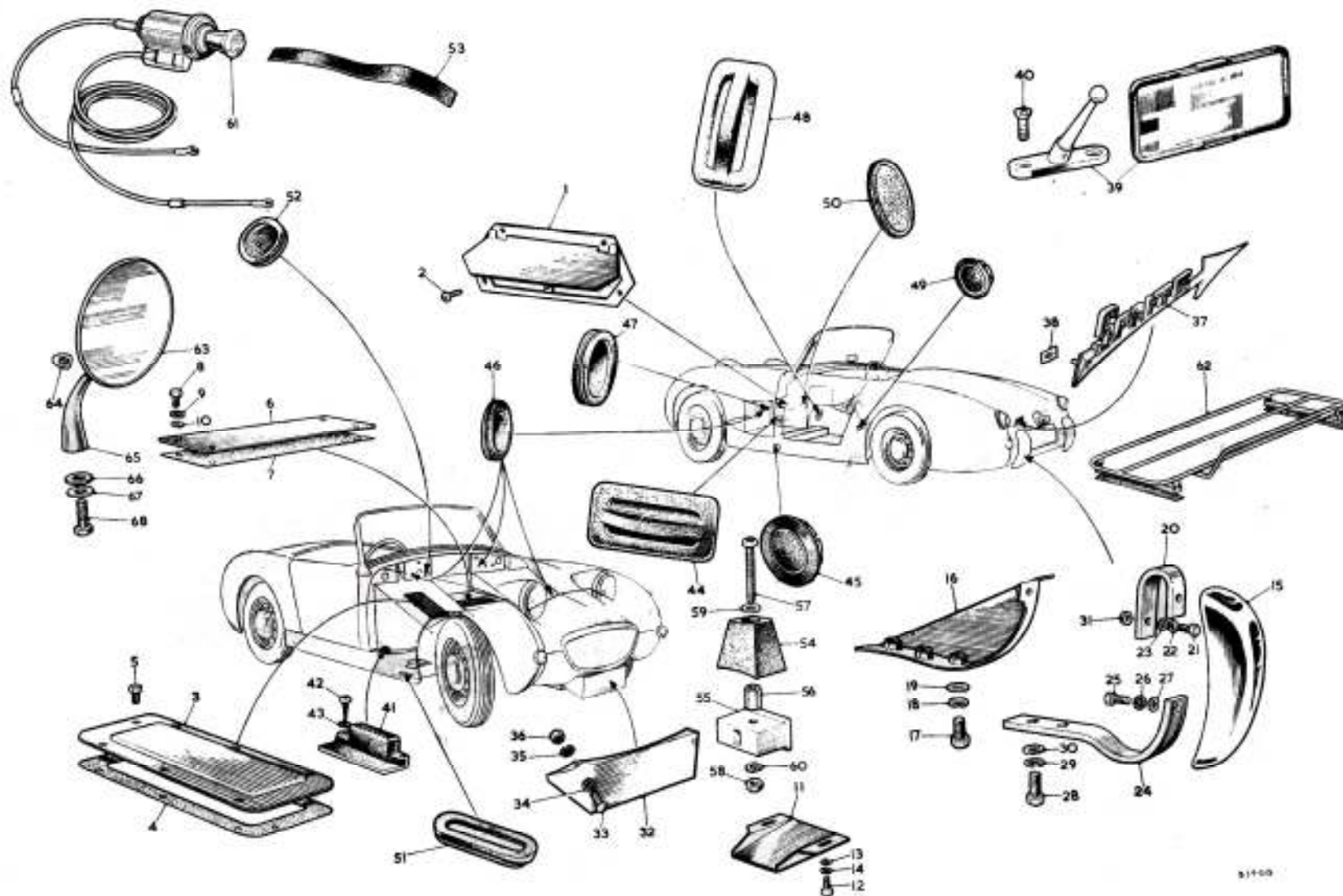

51100

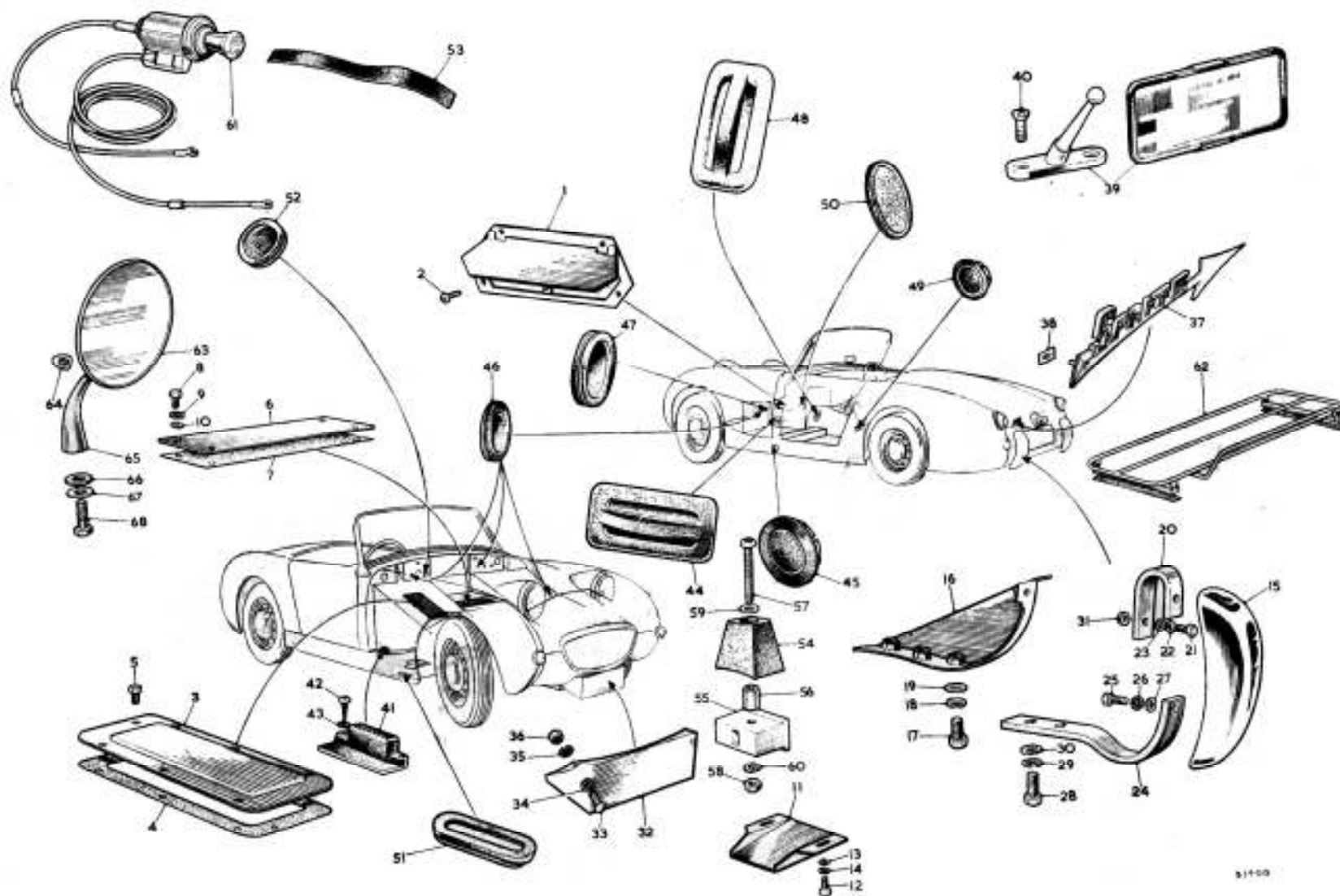

51100



SERVICE PARTS LIST

THE AUSTIN-HEALEY SPRITE

Item No.	DESCRIPTION	Commencing (C) 501		Qty. per Veh.	MODIFICATIONS		REMARKS
		Part Number	Illus. No.		New Part Number	Change Point	
	<b>Sundries—continued</b>						
1	Buffer (rubber)	14A4874	41	4			
2	Screw—buffer to sill panel	PTZ605	42	8			
3	Washer for buffer screw (plain)	PWZ102	43	8			
4	Plug—toebox side—R.H. (rubber)	4G4920	44	1			
5	Plug—sill outer panel (rubber)	2H8188	45	2			
6	Plug—dash blanking (rubber)	RFN210	46	2			Not required when tachometer is fitted
7	Plug—footwell blanking (rubber)	RFN210	46	2			
8	Plug—steering-column hole blanking (rubber)	RFN218	47	1	AHA5437	Com. (C) 7438	
9	Plug—gearbox filler hole blanking (rubber)	4G4920	48	1			
10	Plug—propeller shaft oiling hole blanking (rubber)	4G1851	49	1			
11	Grommet—demister outlet hole blanking	4G9768	50	2			
12	Grommet—slinging hole in main floor blanking	4G0957	51	2			
13	Grommet—heater control blanking	4G2541	52	1			To be pierced when heater is fitted
14	Ferrule—tool hole in rear cross-member panel blanking (1/4" [9.52 mm.])			2	RFN206	Com. (C) 5321	
15	Prestik sealer (1/4" x 1/8" [12.7 mm. x 1.587 mm.])	ADE1590	53	A/R			
16	Prestik sealer (1/4" [9.175 mm.] dia.)	ADE1600		A/R			
17	Seal-a-strip (1/4" [9.175 mm.] dia.)	ADE1584		A/R			
18	Buffer—bonnet			2	ALA1716		
19	Block—buffer packing			2	AHA5400		
20	Distance tube—buffer			2	AHA5899		
21	Screw—buffer and block to wheel arch			2	PMZ0828	Com. (C) 6068	
22	Nut for screw			2	FNZ108		
23	Washer for nut (plain)			2	PWZ208		
24	Washer for nut (spring)			2	LWZ208		
25	Lighter—cigar	AHH5759		1			
26	Luggage grid kit			1	AHA5467	Com. (C) 4333 except 4471, 4622, 4680, 4684	
27	Mirror—wing	BHA4066		2			
28	Head assembly	14A8196		2			Part No. Change. Was 37H9914
29	Nut—dome	14A8226		2			Part No. change. Was 37H9786
30	Stem assembly	37H9915		2			
31	Washer (rubber)	37H9917		2			
32	Washer (steel)	PWZ205		2			Part No. change. Was 37H9916
33	Bolt	HZ50506		2			Part No. Change. Was 37H9788